

ACCESORIOS ROSCADOS

Rosca BSP conforme ISO 7/1 (DIN 2999)

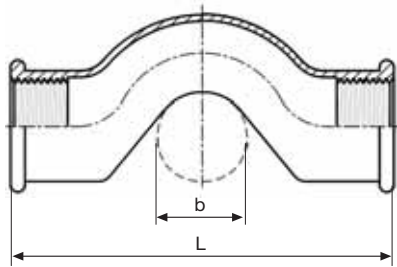

Curva puente

FIG 85

Acero Inoxidable EN 1.4409/316

Código	D	L mm	Peso kg/u.
504F085010	3/8"	78	0,13
504F085015	1/2"	91	0,19
504F085020	3/4"	106	0,27
504F085025	1"	119	0,51
504F085032	1.1/4"	150	0,90

